

# G-POWER

Geared modernization



# Efficient. Economical. Energy-saving.

Older traction elevators are less reliable and performance can deteriorate. This means increased maintenance, service calls and safety-related concerns.

Our G-Power modernization package replaces the critical components of your traction elevator. We replace your direct current (DC) hoist motor with a new high efficiency, maintenance free alternating current (AC) hoist motor. The existing machine, including gears, sheaves and bedplates will be cleaned and refurbished as well. You'll feel the difference the first time you step into your elevator.

## G-Power performance package overview:

### 1 TAC series controller

Our digital controller increases your elevator's reliability, reduces wiring and optimizes efficiency. The controller also includes:

- **Advanced 32-bit microprocessor**  
Automatically adjusts the controller to high-traffic demand, helping improve your elevator's energy efficiency.
- **VVVF AC regenerative drive**  
Captures unused energy created by your elevator and feeds it back into the power grid.
- **Absolute positioning system**  
Precisely measures your elevator's speed and positioning. This promotes accurate floor stopping, so floors are level and passengers are safe.
- **Load weigher technology**  
Eliminates stops when the elevator is fully loaded, improving ride efficiency.
- **Non-proprietary user interface tool (UIT)**  
Provides easy access to diagnostic equipment for adjusting, maintaining and troubleshooting your elevator.
- **MAX**  
Provides real-time, cloud-based predictive maintenance, reducing your elevator's downtime

### 2 Motor

An AC motor will replace your DC motor. It includes custom motor coupling and an integrated velocity encoder package.

### 3 Universal door operator

Faulty doors are the elevator industry's most frequent service call. This new technology improves door reliability and provides quick and smooth door operation.

### 4 Wiring package

Our cable and hoistway wiring system communicates with multiple devices through a single wire using advanced CAN-BUS technology. It helps provide safer and more efficient elevator operations and maintenance.

### 5 MOD Fusion fixtures

Our stainless steel fixture line includes car operating panels, hall fixtures and car riding lanterns that improve elevator appearance and functionality. Fixtures are also easy to install, do not damage the walls and are in full compliance with U.S. and Canadian fire service codes.

### Geared machine

Passenger simplex or group operations	Up to eight cars in a group
Openings	Front and rear available
Stops	Up to 20 standard (over 20 requires special engineering)
Power supply	200–208V, 220–240V, 460–480V, 575–600V, 60 HZ AC
Speeds	Up to 400 fpm (2 m/s)
Capacity	1500 to 5000 lbs. (680.4 to 2268 kg)
Travel	Existing
Roping/wrap	Reuse existing roping configuration
Machine room location	Overhead, adjacent or basement

Ask your TK Elevator representative about our Advantage Packages, designed to make the G-Power modernization process as quick and convenient as possible for you and your tenants.

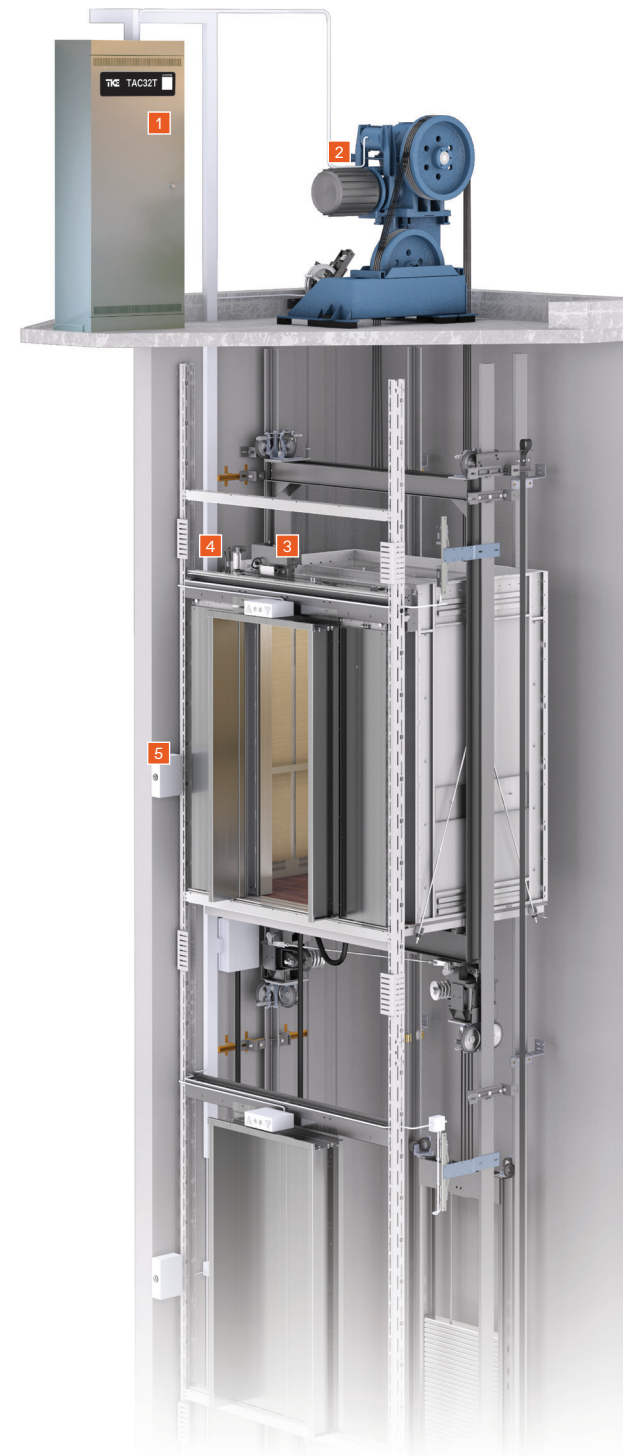

## MOD Fusion fixtures:

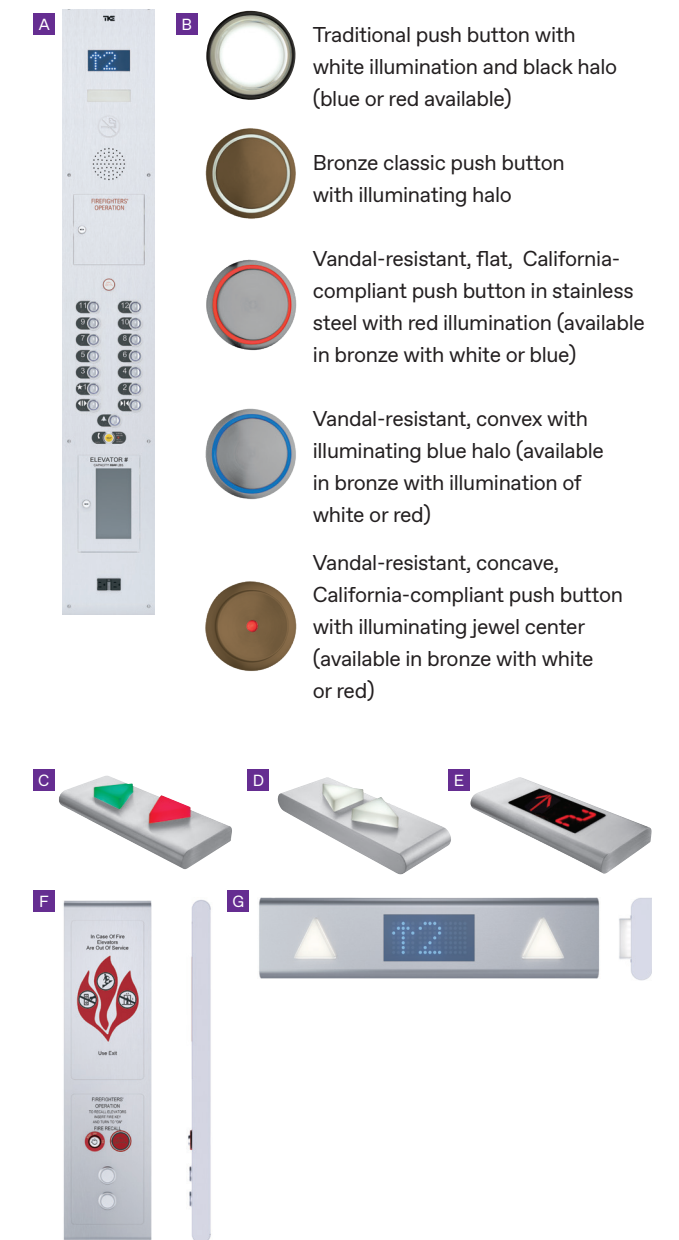

- A Car operating panel
- B Push button options
- C Horizontal hall lantern (arrows)
- D Vertical hall lantern (arrows)
- E Hall position indicator
- F Intermediate hall station, fire service and appendix H / O signage
- G Combo hall lantern / position indicator

TK Elevator Corporation  
788 Circle 75 Parkway SE  
Suite 500  
Atlanta, GA 30339  
P: +1 844 427 5461  
www.tkelevator.com/us

TK Elevator (Canada) Limited  
2075 Kennedy Rd., Suite 600,  
Scarborough, ON M1T 3V3  
P: 416 291 2000  
www.tkelevator.com/ca



All illustrations and specifications are based on information in effect at time of publication approval.  
TK Elevator reserves the right to change specifications or design and to discontinue items without prior notice or obligation.  
© 2021 TK Elevator Corporation. © 2021 TK Elevator (Canada) Limited. CA License #C11-651371 | 27431 | G-Power modernization brochure