

GL - POWER

Gearless modernization



MOVE BEYOND

Efficient. Economical. Energy-saving.

Aging gearless elevators can decline in performance, creating a negative perception of your high-rise building. The elevators can also significantly increase your building’s energy costs.

Our GL-Power solution includes gearless machine technology and a permanent magnet AC motor, providing significant performance enhancements and energy savings. You’ll feel the improvements the first time you step into your elevator.

GL-Power performance package overview:

1 TAC series controller

Our digital controller increases your elevator’s reliability, reduces wiring and optimizes efficiency. The controller also includes:

- **An advanced 32-bit microprocessor**
Automatically adjusts the controller to high-traffic demand, helping improve your elevator’s energy efficiency.
- **VVVF AC regenerative drive**
Captures unused energy created by your elevator and feeds it back into the power grid.
- **Absolute positioning system**
Precisely measures your elevator’s speed and positioning. This promotes accurate floor stopping, so floors are level and passengers are safe.
- **Load weigher technology**
Eliminates stops when the elevator is fully loaded, improving ride efficiency.
- **Non-proprietary user interface tool (UIT)**
Provides easy access to diagnostic equipment for adjusting, maintaining and troubleshooting your elevator.
- **MAX**
Provides real-time, cloud-based predictive maintenance, which increases your elevator’s uptime.

2 Machine

The advanced gearless machine has an AC motor that only runs when the elevator is in use. It provides a smooth ride with minimal vibrations.

3 Universal door operator

Faulty doors are the elevator industry’s most frequent service call. This new technology improves door reliability and provides quick and smooth door operation.

4 Wiring package

Our cable and hoistway wiring system communicates with multiple devices using a single wire using advanced CAN-BUS technology. You’ll have improved elevator operations and simplified maintenance.

5 Fusion fixtures

Our stainless steel fixture line includes car operating panels, hall fixtures and car riding lanterns that improve elevator appearance and functionality. Fixtures are also easy to install, do not damage the walls and are in full compliance with U.S. and Canadian fire service codes.

Gearless machine	
Passenger simplex or group operations	Up to eight cars in a group
Openings	Front and rear available
Stops	Up to 20 standard (over 20 requires special engineering)
Power supply	200–208V, 220–240V, 460–480V, 575–600V, 60 HZ AC
Speeds	Up to 500 fpm (2.5 m/s)
Capacity	2100 to 3500 lbs. (680.4 to 2268 kg)
Travel	350’–0” (106.88 m)
Roping/wrap	1:1 single wrap only
Machine room location	Overhead only

Ask your TK Elevator representative about our Advantage Packages, designed to make the GL-Power modernization process as quick and convenient as possible for you and your tenants.



MOD Fusion fixtures:

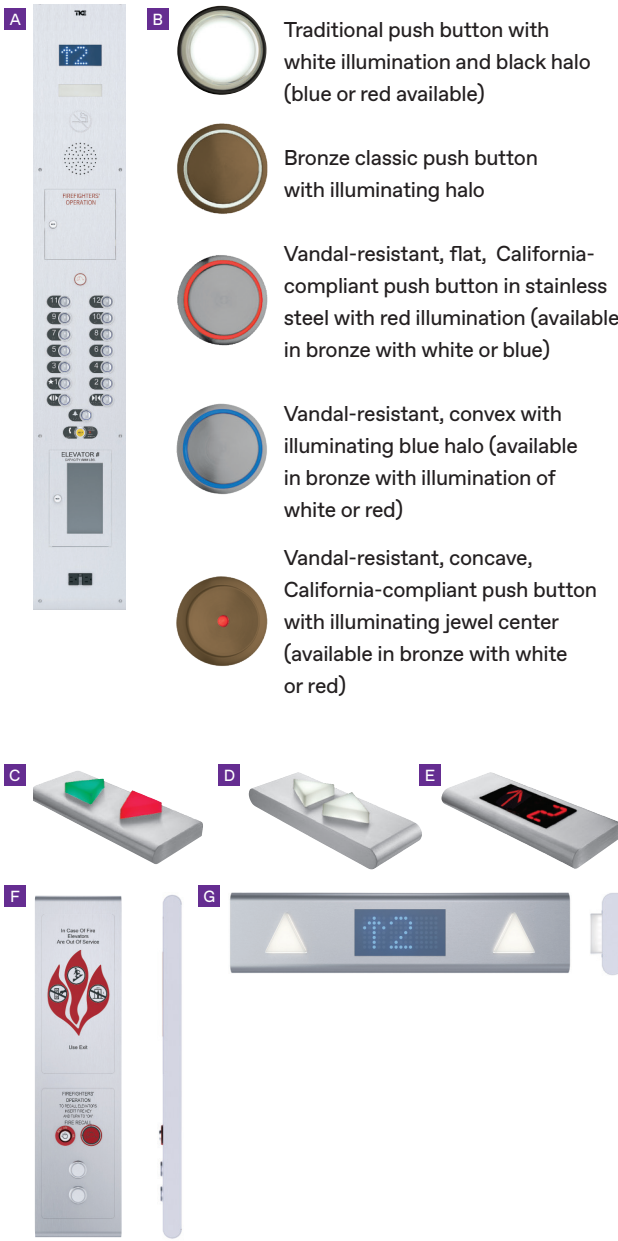

- A Car operating panel
- B Push button options
- C Horizontal hall lantern (arrows)
- D Vertical hall lantern (arrows)
- E Hall position indicator
- F Intermediate hall station, fire service and appendix H / O signage
- G Combo hall lantern / position indicator

TK Elevator Corporation
788 Circle 75 Parkway SE
Suite 500
Atlanta, GA 30339
P: +1 844 427 5461
www.tkelevator.com/us

TK Elevator (Canada) Limited
2075 Kennedy Rd., Suite 600,
Scarborough, ON M1T 3V3
P: 416 291 2000
www.tkelevator.com/ca



INTERNATIONAL
LIVING FUTURE
INSTITUTE™

All illustrations and specifications are based on information in effect at time of publication approval.
TK Elevator reserves the right to change specifications or design and to discontinue items without prior notice or obligation.
© 2021 TK Elevator Corporation. © 2021 TK Elevator (Canada) Limited. CA License #C11-651371 | 274.35 | GL-Power modernization brochure